

Whilst every attempt has been made to ensure the accuracy of the floor plan contained here, measurements of doors, windows, rooms and any other items are approximate and no responsibility is taken for any error, omission, or mis-statement. This plan is for illustrative purposes only and should be used as such by any prospective purchaser. The services, systems and appliances shown have not been tested and no guarantee as to their operability or efficiency can be given
 Made with Metropix ©2021

GROUND FLOOR

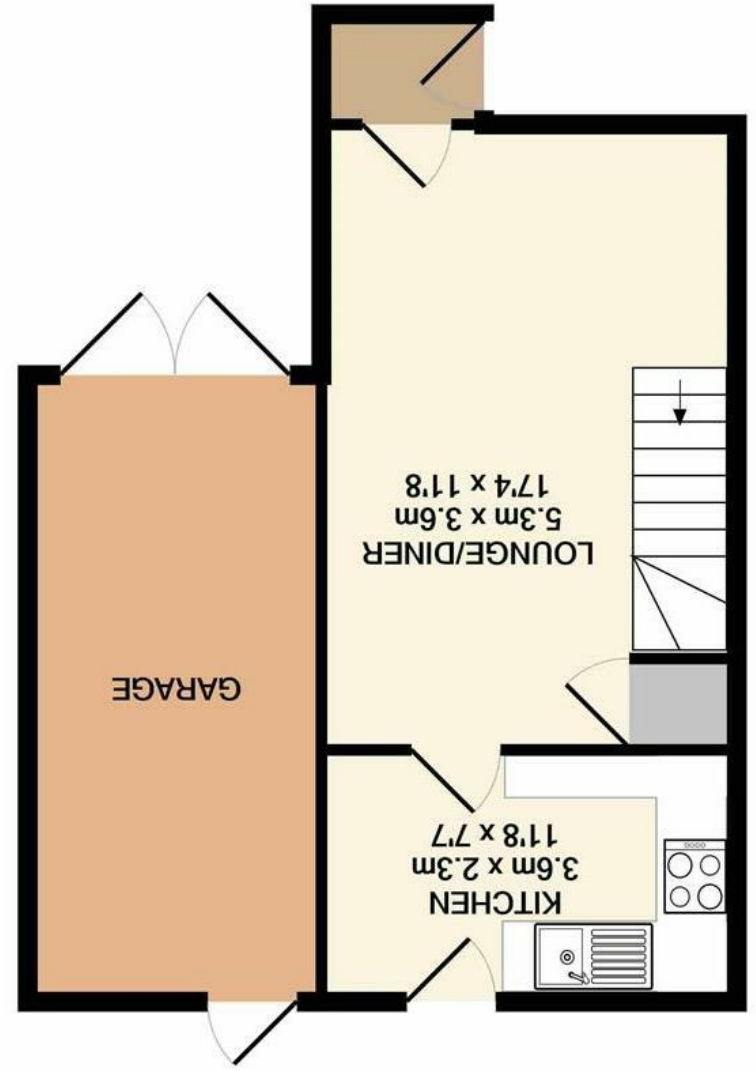

1ST FLOOR

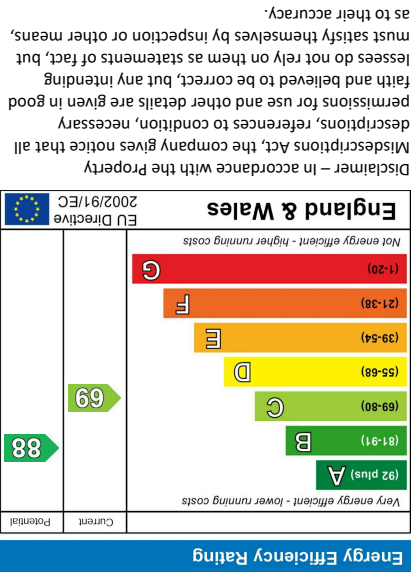
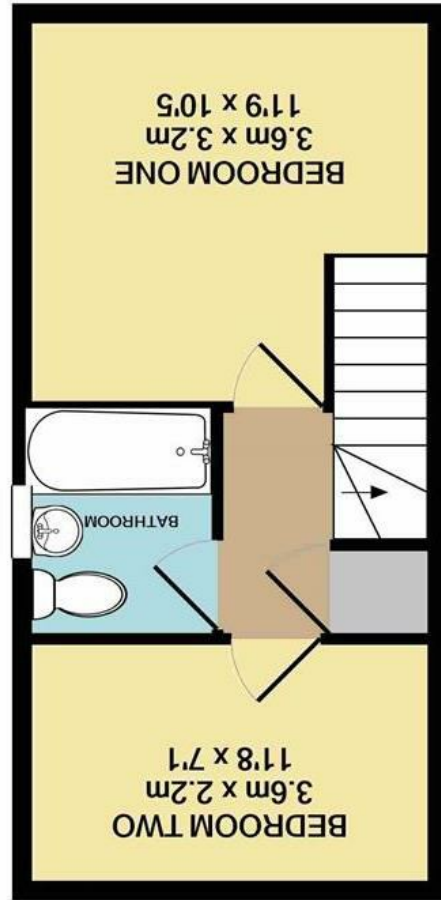

"Costessey is such a convenient location with many local facilities on hand and with easy access to both Norwich City Centre and the countryside. I particularly love the views to the rear of this property, which offer a real sense of space within a residential setting"

Wood View Court | Norwich | NR5
 Guide Price £195,000





abbotFox presents this ideal first time buy. Located within a quiet close and occupying an elevated position with views to the rear over nearby woodlands and fields, this home has been thoughtfully improved by the current owners. With the property ideally located within easy reach of a variety of local amenities, this property offers two double bedrooms and family bathroom to the first floor, with an entrance porch, lounge diner and kitchen to the ground floor. Externally this home benefits from both front and rear gardens with driveway parking and an adjoining garage. The rear garden offers a high degree of privacy in the summer months. An internal viewing comes highly recommended to appreciate this home.

